

NextLight Starter Guide

716GE-I Optical Network Terminal (ONT)



1. Locate the **white NextLight wall plate** and carefully lift the hatch from the bottom to expose the fiber port connections. Locate the nearest power outlet to the wall plate.



2. Remove the ONT hood cover using a **Phillips-head screwdriver** and carefully remove the cap found on the fiber port of your ONT.

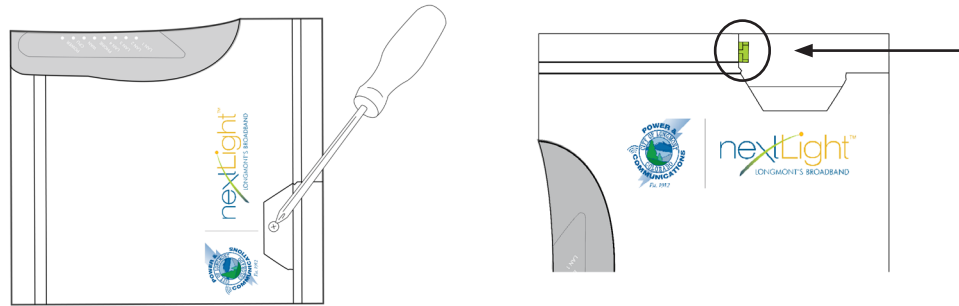

3. Carefully remove the plugs found on the ends of the yellow-and-green fiber cable, ensuring not to touch the end of the cable once the plugs have been removed.

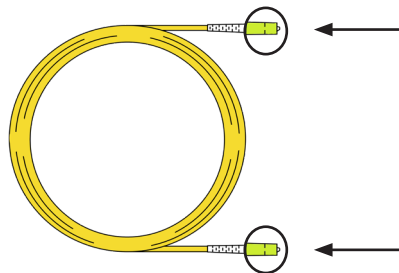

4. Making sure the notch on the fiber cable is aligned with the slot on the fiber port, plug the yellow-and-green fiber cable into the fiber port on the ONT and reattach the cover.

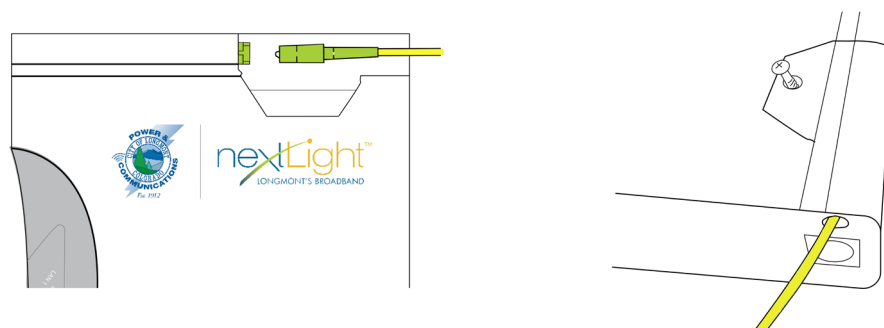

5. Plug the other end of the yellow-and-green fiber cable already attached to your ONT into the white NextLight wall plate; making sure the notch on the yellow-and-green fiber cable is aligned with the slot on the NextLight wall plate.



6. Plug the power cord into the ONT, making sure all pins are straight and aligned correctly with the power cord port. Then plug the power cord into the nearest available outlet.

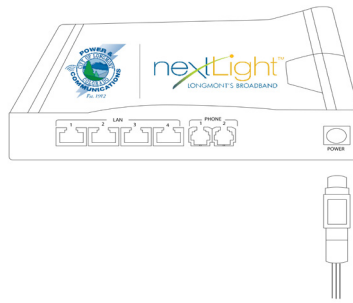

7. Connect a Cat 5E or Cat 6 Ethernet cord in port 1 of your ONT.

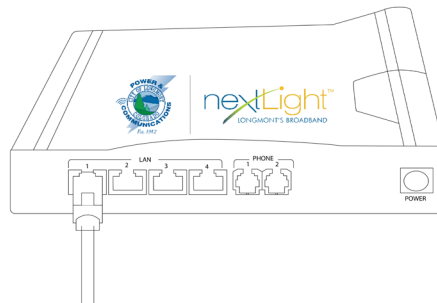

8. Connect the other end of the Ethernet cord into the Internet/WAN port of your router. About 5 minutes after powering the unit on, the Power, CPU, and WAN lights should be lit orange.

